

Commissioning Instructions

ISQ/ISQ-F version A01, B01

Prerequisites

The ISQ unit needs to be connected with 24 VAC + CAN via the CBD control box. To commission the ISQ unit the operator needs a user account for LINDINSIDE.

Commissioning with mobile app LINDINSIDE
ISQ is commissioned by assigning the unit a unique Node-ID, and by setting a number of parameters. With ISQ the smartphone is introduced as a handset which is communicating directly with the ISQ unit about to be commissioned or in need of a update. With the app LINDINSIDE installed, the mobile phone connects with Bluetooth® to the ISQ unit. The air diffusers control unit together with Bluetooth® and other sensors is located under the bottom plate.

Guidance LINDINSIDE

On the next page, you will find a short guide on how to set the Node-ID on site when commissioning Lindinvent's control units with the LINDINSIDE app.

The LINDINSPECT® visualization tool

When the air diffusers Node-ID has locally been set then other settings can be made centrally through the web-based visualization- and administration tool LINDINSPECT®.

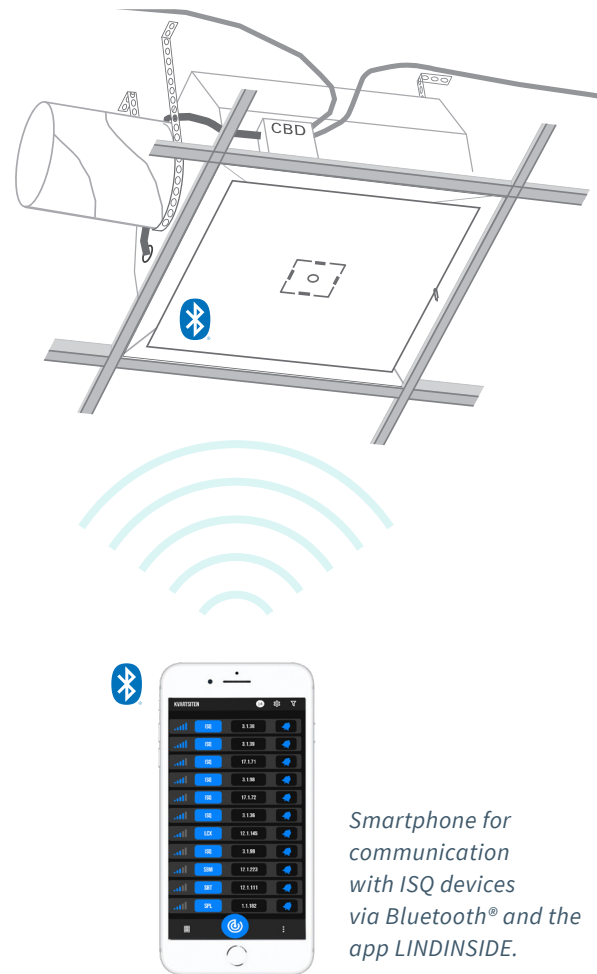

Smartphone for communication with ISQ devices via Bluetooth® and the app LINDINSIDE.

Workflow when assigning Node-ID (See page 2 for screenshots from LINDINSIDE)

1. Download the app and scan:

- LINDINSIDE can be downloaded to your smartphone from Google play / App Store. Do you want help finding the links? Scan the QR code and you will come to the product page for LINDINSIDE where the links are.
- Activate the LINDINSIDE app.
- Pull down to scan available devices. LINDINSIDE then lists all ISQ devices that are within signal distance.

2. Select the correct ISQ device from the list:

By activating a buzzer in the device, it can be easily identified. A signal confirms that the device has contact with your smartphone.

3. Set assigned Node-ID on selected device:

Enter a unique Node-ID between 1–254 according to the recommended division of Node-ID from Lindinvent. Remember that Node-ID must not be 0.

4. Perform a new scan / refresh for control:

Perform a new scan to verify the updated Node-ID. If the Node-ID isn't updated, select the device again and repeat steps 3 and 4 until the correct Node-ID is displayed.

Read more about
LINDINSIDE

Download on the
App Store

GET IT ON
Google Play

Set Node-ID with LINDINSIDE

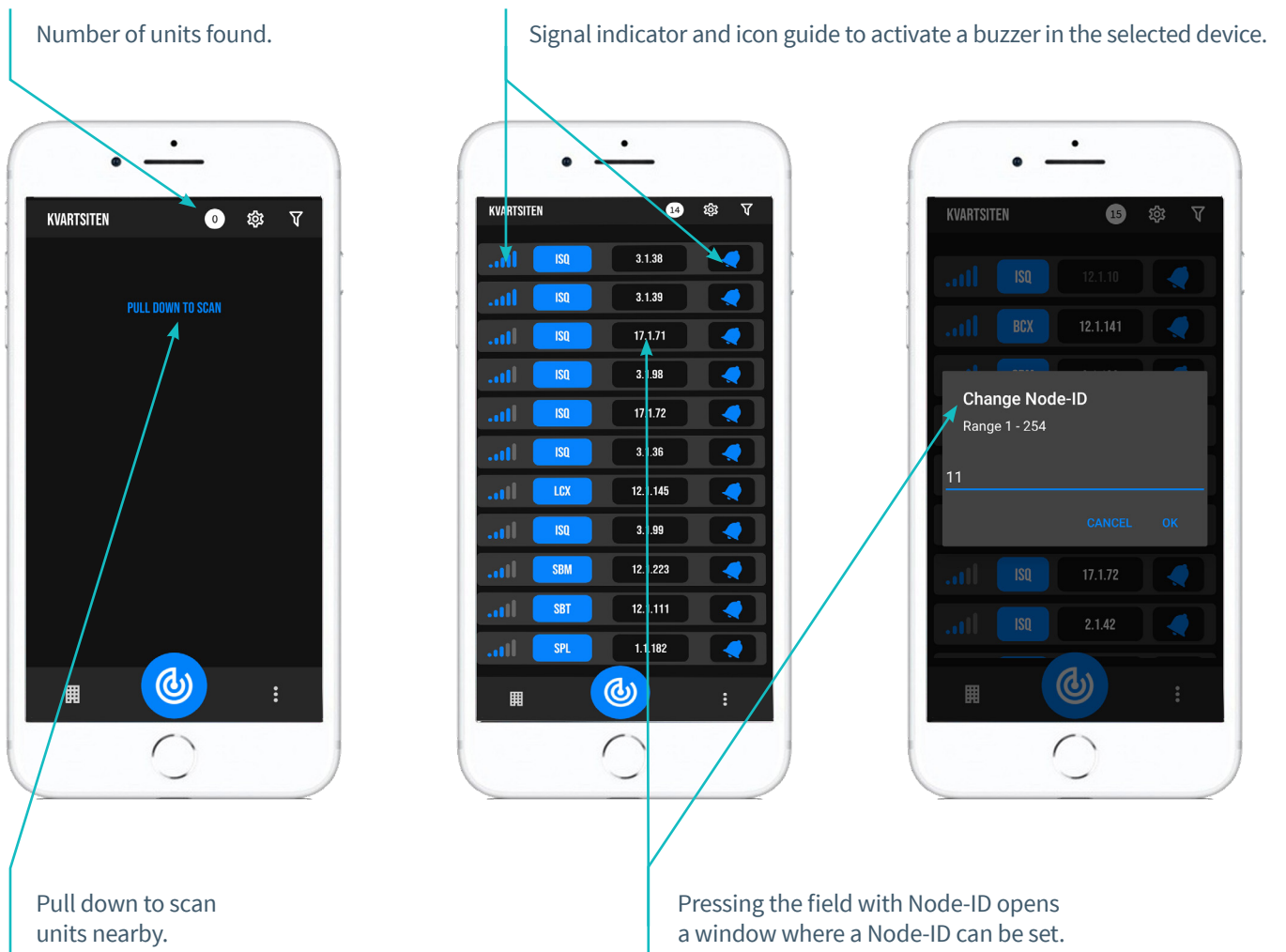

Features in LINDINSIDE

Show actual values

A selection of values is displayed depending on the selected control unit.

Test mode

Possibility to temporarily set the control unit in different defined operating modes.

Test value

Input to Test mode.

LED / Buzzer

Settings to select how test results should be indicated on the unit with optional light and sound.

Reset / Factory reset

Possibility to do a limited reset or a complete factory reset to original settings with default values.