

Installation Instructions

Points to Note Before Installation

Terminals are generally delivered on a pallet, with each terminal in a marked cardboard box.

- ☐ Ensure the terminal has the correct placement of the duct connection [L, B, R]. See the marking on the packaging.
- ☐ The delivery unit consists of:
 - Terminal box with connected CBD junction box
 - Mounting frame
 - Grille module with electronics board
 - 2 sheet metal screws
- ☐ Materials not included in the delivery:
 - Sealing material for wall/terminal box duct side

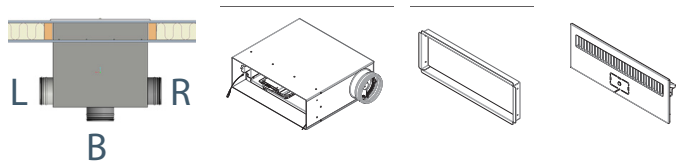

Installation of Terminal Box and Mounting Frame in Wall:

1. Hole Cutting

Create an opening through the wall.

Inner dimensions according to the figure:
Approximately 560 (W) x 200 (H) mm.
Minimum distance to the ceiling: > 25 mm.

2. Place and Anchor the Terminal Box

Position the terminal, from the duct side, in the wall so that the front of the terminal is level with the inner wall of the ventilated space (A).

Provide support against the floor slab at the rear (B).

Use caulking or sealing compound to seal between the wall and the terminal box.

3. Place and Anchor the Mounting Frame

Position the mounting frame in the terminal opening so that it meets the terminal box internally and lies against the surrounding inner wall externally (A).

Anchor the mounting frame and terminal box in the wall by installing screws through the pre-drilled holes (2 screw holes on each inside (B)).

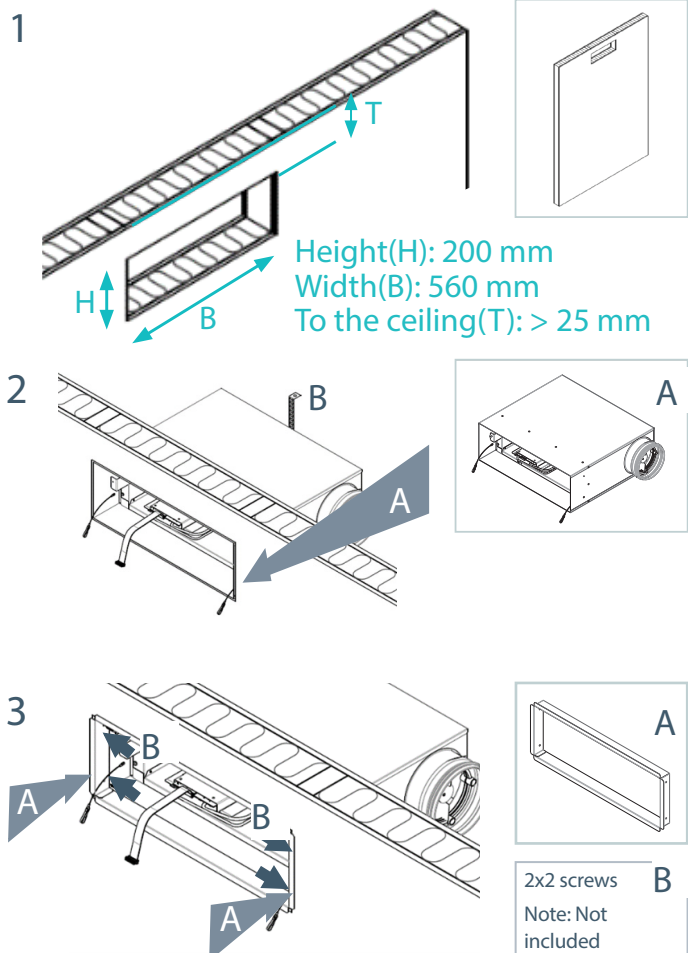

Installation of Front Grille with Circuit Board

1. Hang the Grille Module

Attach the grille module (A) to the two hanging wires using the carabiners (B) from the terminal box. Let the grille module hang down with the front facing the wall in preparation for connecting the wiring from the terminal box.

2. Connect the Wiring to the Circuit Board

With the grille module hanging on the carabiners:
*Connect the cable (A) from the terminal box to the short side of the circuit board on the front grille. The white connector can only be attached one way.

3. Prepare the Sensor and Attach the Grille

Remove the protective tape over the sensor opening in the center of the grille module's front plate. Ensure that the temperature sensor (A), which was held back by the tape, protrudes into the room from the terminal.

Lift the grille module so that the front plate aligns correctly over the terminal opening towards the room (B).

Secure the grille module to the terminal box with the two provided sheet metal screws (C). The terminal box has designated screw holes for this attachment.

4. Placement of the CBD Junction Box

The CBD junction box, included with the terminal upon delivery, is equipped with magnets for easy placement on the most suitable spot on the terminal box.

After connecting the supply air duct and wiring the CAN + 24 VAC via the junction box, the wall terminal is ready for commissioning.

