

## DELIVERY UNIT PRESENTATION

The components are presented below. All parts are packed together and usually delivered on a pallet.

### Plenum box with connection box CBD

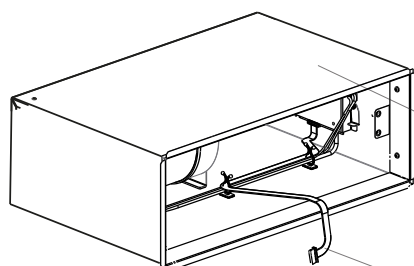

#### Plenum box

The plenum box contains control electronics, an air flow damper and an airflow measuring device.

#### Cable to spreader part

The spreader part is mounted on-site. After the plenum box is positioned in the wall, the cable from the control electronics is connected.

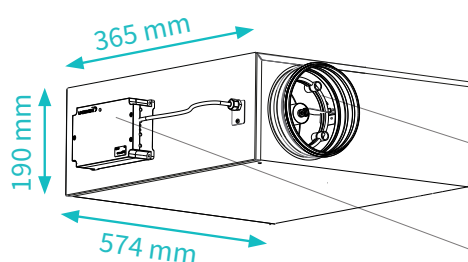

#### Airflow measuring device

An airflow measuring device is mounted in the inlet to the airflow damper.

#### Kopplingsbox CBD

CBD är ansluten vid leverans (kabellängd enligt beställning). Kapslinen till CBD är utrustad med magneter för enkel och flexibel positionering men har också skruvöron för infästning på annan plats.

Donlådan klar för placering i vägg direkt från pall.

### Mounting frame

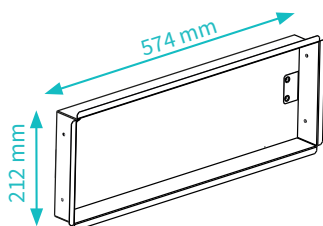

#### Mounting frame

The frame functions as a frame against the wall, a wall bracket, and a holder for the spreader part.

The mounting frame.

### Spreader part

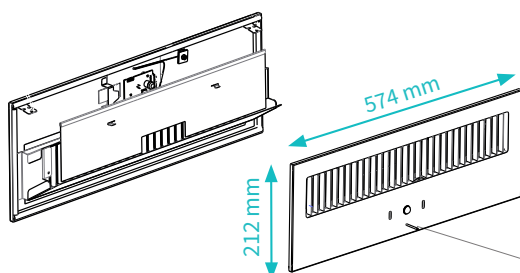

#### Detachable spreader part

Powder-coated unit with grids for an adjustable vertical air distribution pattern and sensor openings. Sensors and a holder for expansion cards are located on the back of the unit.

#### Room temperature sensor

The sensor is located centrally on the lower part of the spreader part front panel, just below the presence sensor.

The spreader part's back side and front panel side.

## Installation Instructions (Step 1 to 8)



### Points to notice (ahead of installation)

- ☐ Before unpacking the unit, check the duct connection side. [LR stands for left-side or right-side duct connection. B stands for rear-side duct connection.] See the packaging labelling.

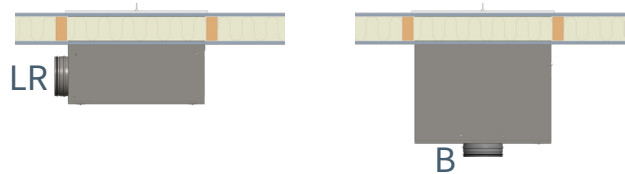

- ☐ Check that the delivery unit is complete:
  - The plenum box with connection box CBD
  - The mounting frame
  - The spreader part with sensors
- ☐ Materials not included in delivery:
  - Sealing material
  - 4 x screws for wall mounting

### Plenum box installation:

#### 1. Hole cutting

Create an opening through the wall.

Inner dimensions:

Approximately 560 (W) x 200 (H) mm.

Minimum distance to the ceiling: > 25 mm.

#### 2.Placement

The box is inserted from outside the room so that the front is just level with the inner wall.

#### 3.Relieve and seal

Relieve against the joists at the rear edge.  
Seal-off between the wall and the diffuser.

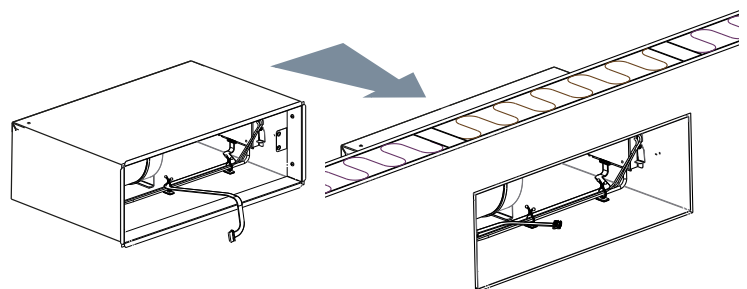
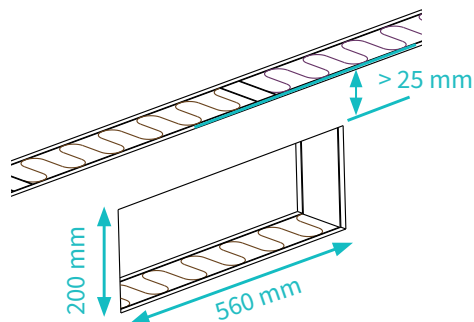

### Connection box CBD:

#### 4. Placement of CBD

CBD is placed on the plenum box using the housing's magnets or in another location using screws.

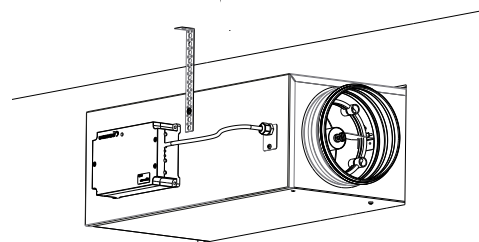

## Installation Instructions

### Mounting frame installation

#### 5. Insert and fasten the frame

Insert the mounting frame into the plenum box opening until it frames the wall opening. The frame is screwed from the inside into the wall together with the plenum box via four pre-drilled holes.

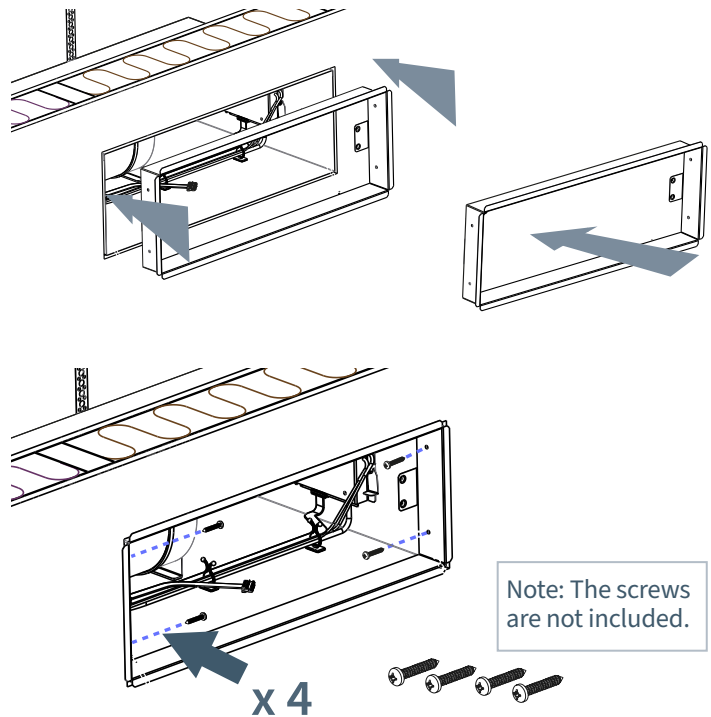

### Spreader part installation

#### 6. Connecting the control unit

Connect the cable to the circuit board on the spreader part while holding the bottom edge at an angle away from the wall to avoid damaging the room temperature sensor.

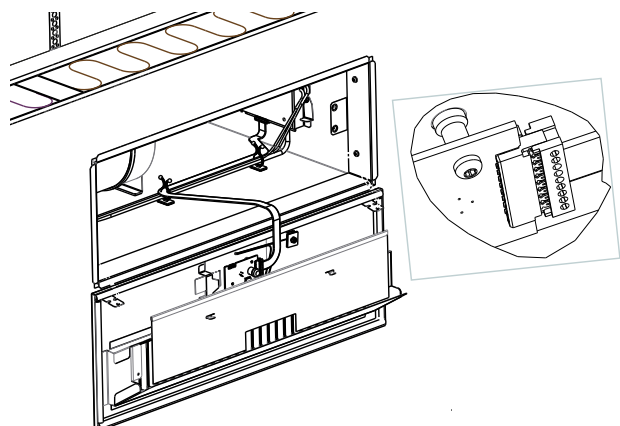
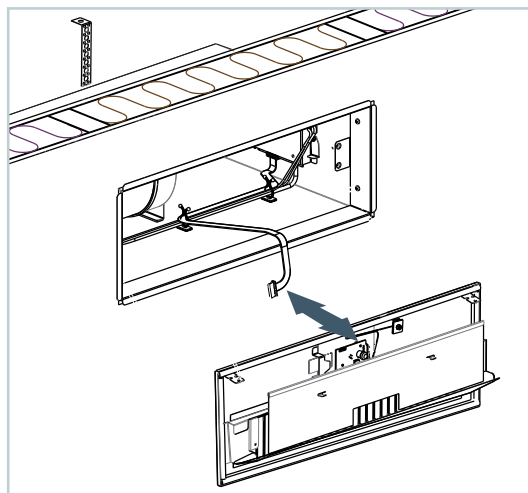

## Installation Instructions

### 7. Attach the spreader part

After the cable has been connected, turn the spreader part up and place it in the mounting frame.

Attach the diffuser part with the two pre-assembled screws located inside the grille.

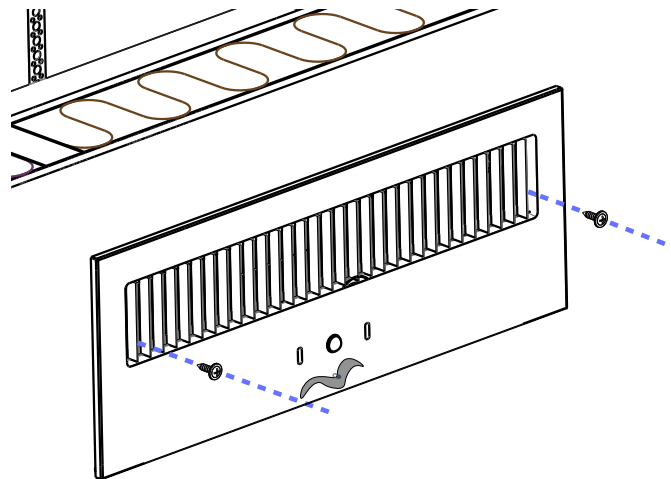
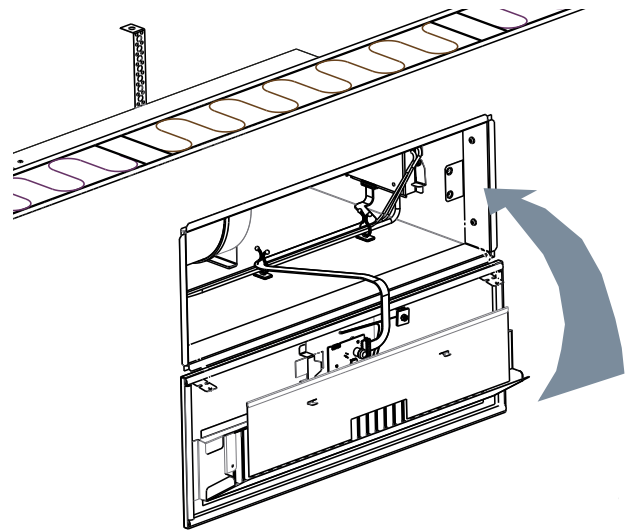

### 8. Position the temperature sensor

Remove the protective tape from the sensor and pull it out to its end position. It should protrude straight into the room for correct measurement.

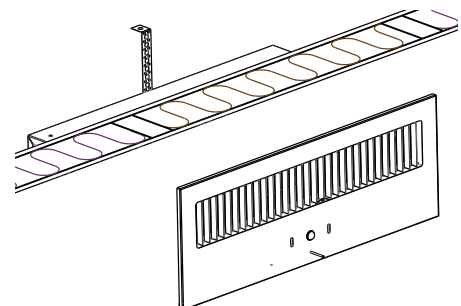
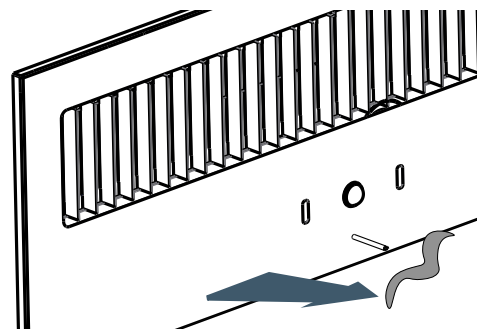

After connecting the supply air duct and connecting CAN + 24 VAC via the junction box, the wall unit is ready for commissioning.